

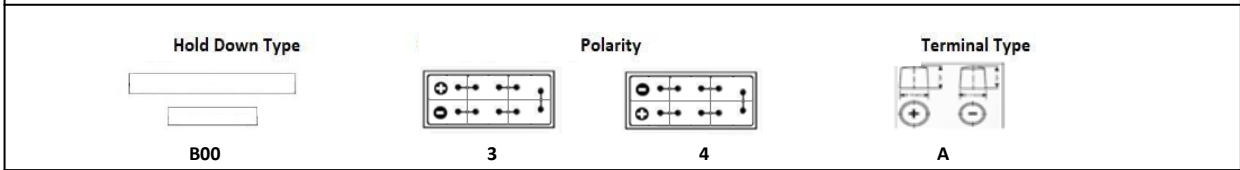

BATERIA EMERS ECOLOGY 220AH / BATTERY TECHNICAL DATASHEET

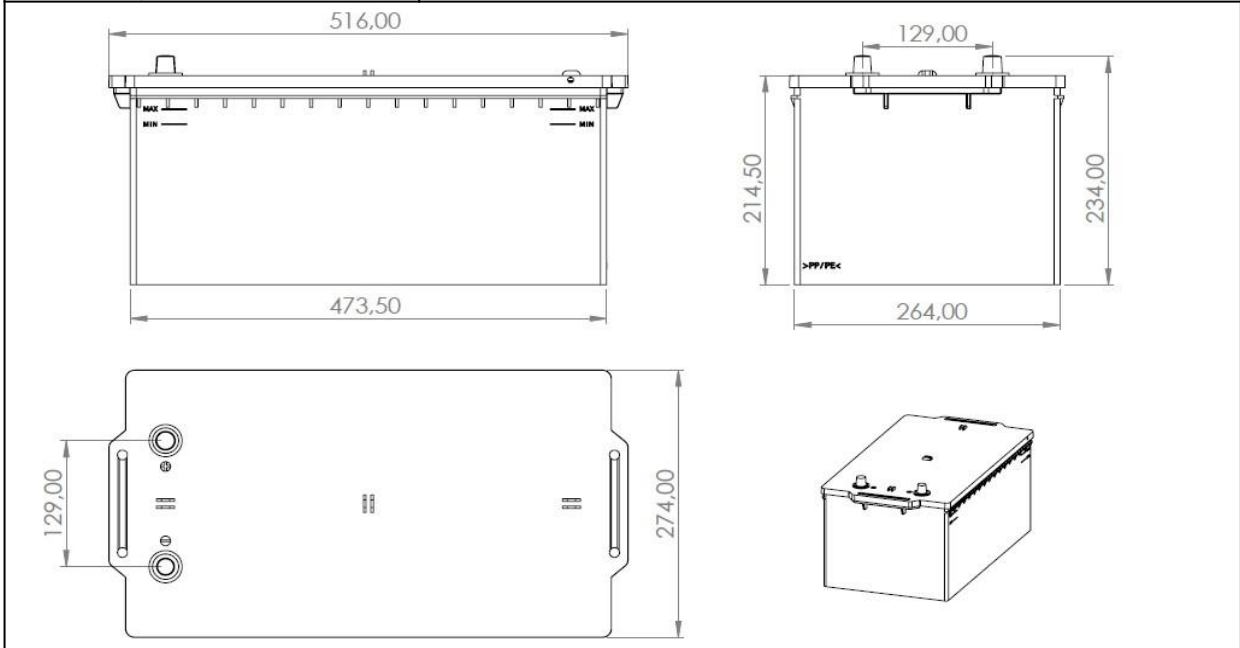

Battery is manufactured according to the UNE-EN-50342-1:2006 and the UNE-EN-50342-4:2010 standards.

Technology	MATRIX PRESS (PUNCH) TECHNOLOGY CALCIUM-CALCIUM SEALED MAINTENANCE FREE (SMF) VIBRATION RESIST
-------------------	---

CAPACITY	
Voltage (V)	12
Capacity (Ah)	220
Cold-Cranking Ampere (A EN)	1200
BOX	
Type	C
Hold Down	B0
LID	
Technology	LEAD ACID CALCIUM CALCIUM
Type	C
Polarity	3
Terminal Type	A (KALIN-THICK)
Charge Indicator	AVAILABLE